

## FLEX+ Bollard Installation Instructions

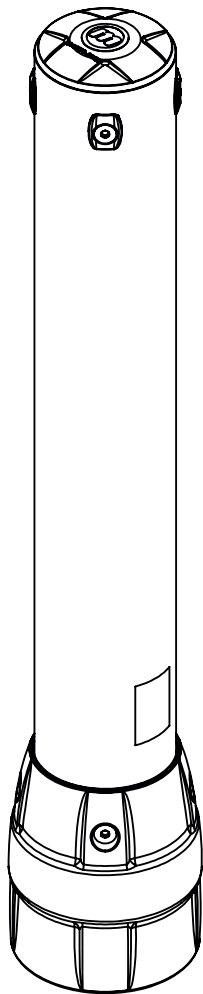

### Components

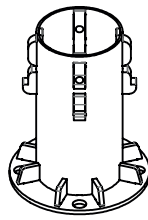

Base floor anchor

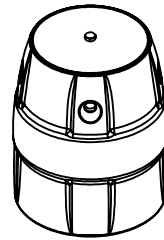

Base incl. fixing materials

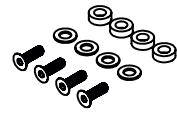

Concrete anchors

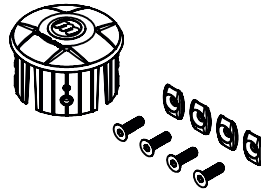

Cover cap incl. fixing materials

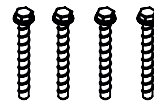

Concrete anchors

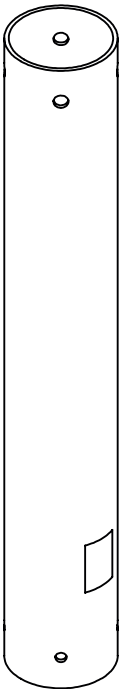

Post

### Required Tools

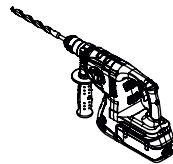

Hammer drill with  
Ø12mm [1/2in] Masonry Bit



Impact driver

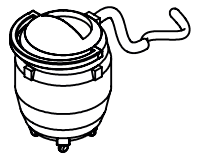

Vacuum



Marker

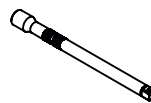

Extender



Hex Socket  
17mm [3/4in]



Hex Bit  
8mm [5/16in]

# Step 1

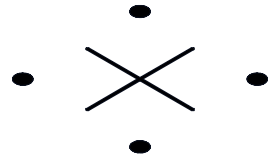
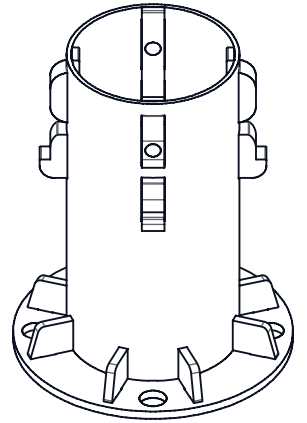
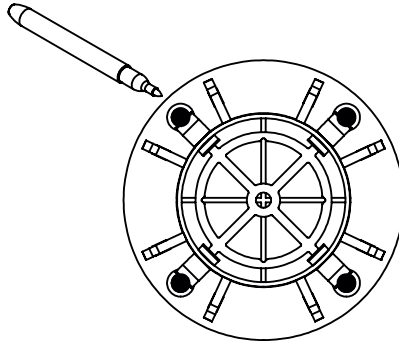
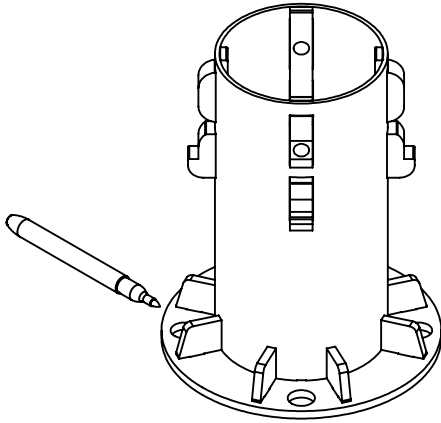
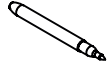

# Step 2

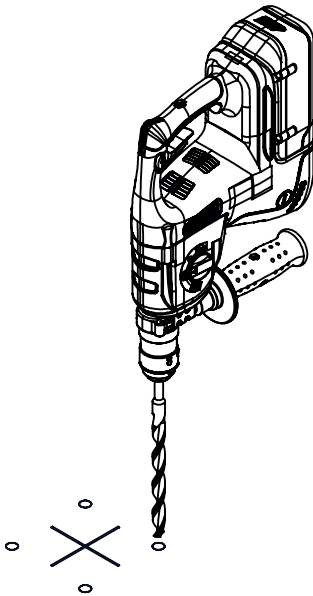
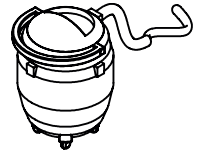
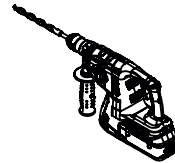

Anchor detail

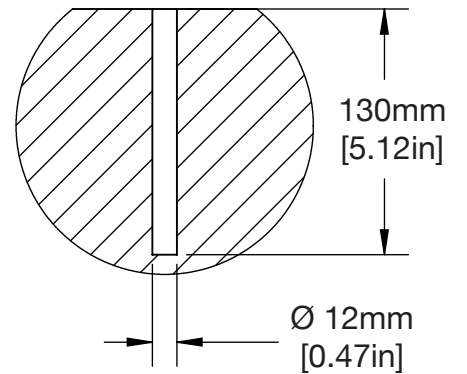

### Step 3

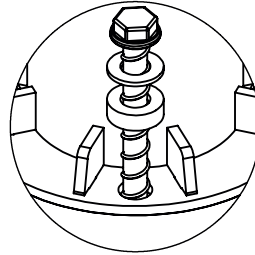
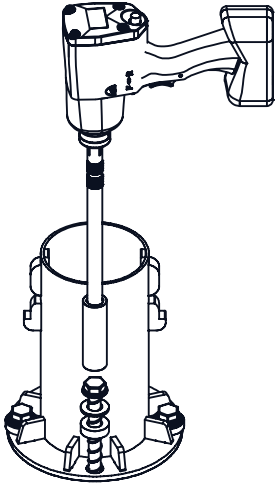
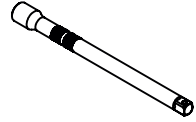
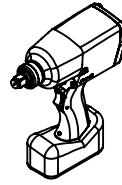

Anchor detail

### Step 4

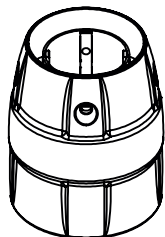
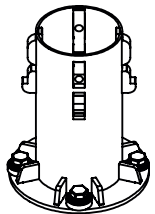
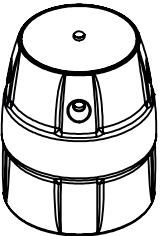
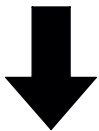

### Step 5

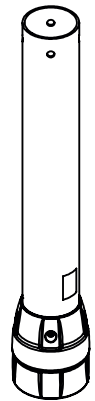
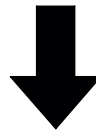

## Step 6

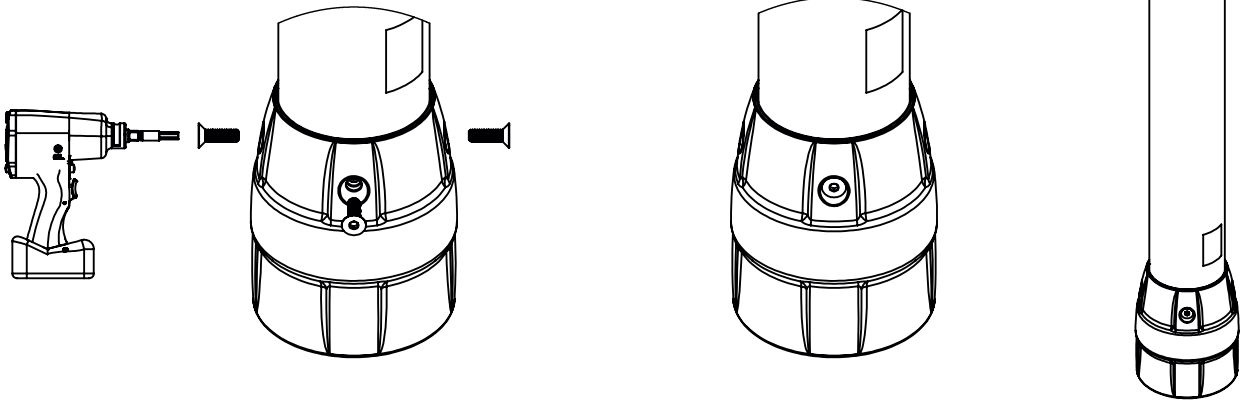
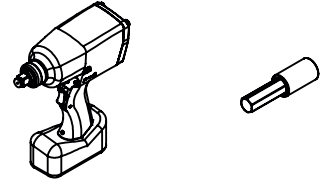

## Step 7

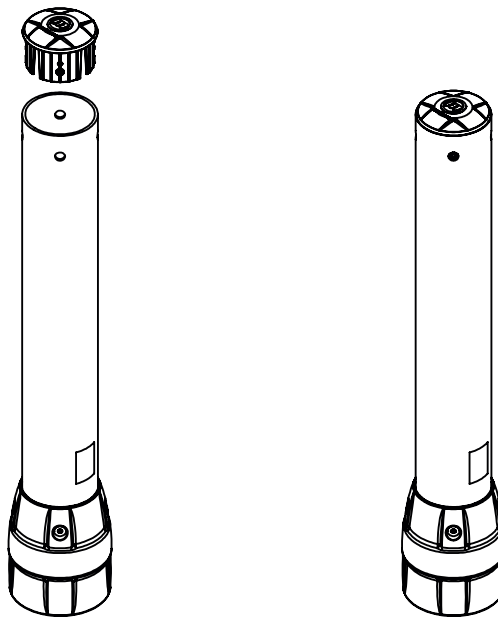
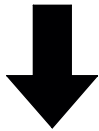

## Step 8

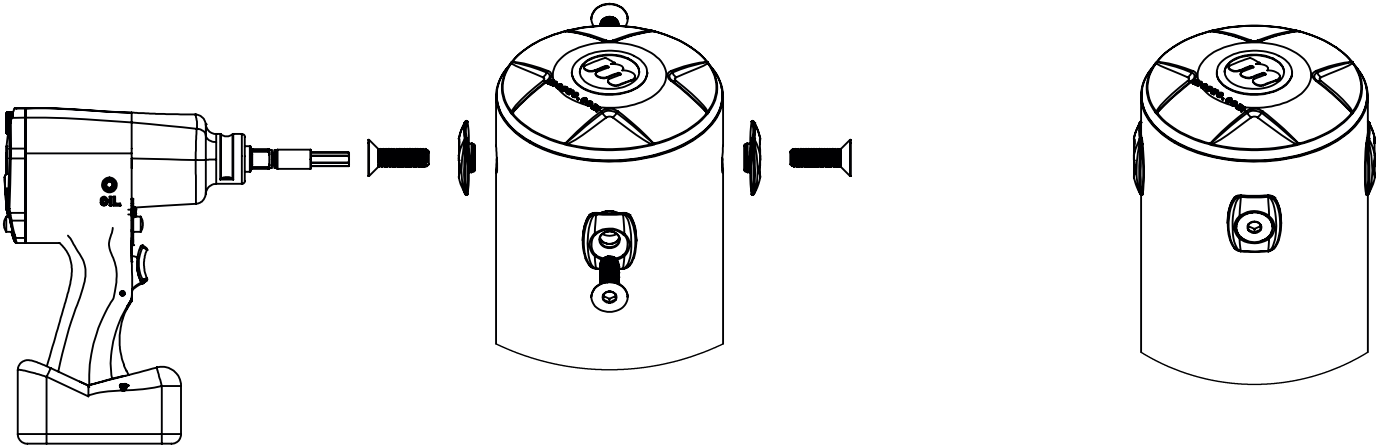
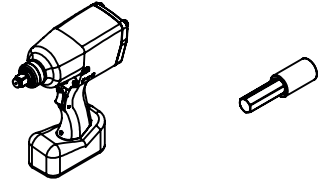

**Installation complete**

